

HEYClip™ Heat Resistant Snap Rivets

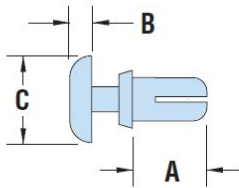

STYLE 1



STYLE 2



- Molded from Nylon 4/6 94V-2 - **heat resistant to 266°F (130°C)**.
- Automotive **tan** (beige) color.
- Designed for fast and easy installation with no tools - just fingertip pressure required.
- Simply place rivet into the hole and press down on the head to fasten; legs expand to securely fasten components.
- Part Description Key: PR X-Y where X = Mounting Hole Diameter (inches) and Y = minimum Panel Thickness (inches).
- Standard Pack - 1,000/bag.

| WILL FIT THESE PANELS | | | | | | PART NO. | DESCRIPTION | PART DIMENSIONS | | | | | | EXTRACTION FORCE | | |
|-----------------------|-----|---------------------------|------|-----|-----|--------------|-------------------|-----------------------|----------|-----|---------------|-----|-----------------|------------------|---|-------|
| MOUNTING HOLE DIA. | | ASSEMBLED PANEL THICKNESS | | | | | | Tan Nylon 4/6 UL94V-2 | A Length | | B Head Height | | C Head Diameter | | N | Style |
| in. | mm. | Min. | Max. | in. | mm. | | | | in. | mm. | in. | mm. | in. | mm. | | |
| PR Tan Series | | | | | | | | | | | | | | | | |
| .122 | 3,1 | .04 | 1,0 | .08 | 2,0 | 9028H | PR 122-039 HR Tan | .14 | 3,5 | | | | | | | |
| | | .08 | 2,0 | .12 | 3,0 | 9030H | PR 122-079 HR Tan | .18 | 4,5 | | | | | | | |
| | | .12 | 3,0 | .16 | 4,0 | 9032H | PR 122-118 HR Tan | .22 | 5,6 | .06 | 1,6 | .25 | 6,4 | 78 | 2 | |
| | | .16 | 4,0 | .19 | 5,0 | 9034H | PR 122-157 HR Tan | .26 | 6,5 | | | | | | | |
| | | .22 | 5,5 | .26 | 6,5 | 9038H | PR 122-217 HR Tan | .32 | 8,0 | | | | | | | |
| .142 | 3,6 | .05 | 1,2 | .08 | 2,1 | 9044H | PR 142-047 HR Tan | .14 | 3,5 | | | | | | | |
| | | .08 | 2,1 | .12 | 3,0 | 9046H | PR 142-083 HR Tan | .18 | 4,5 | | | | | | | |
| | | .11 | 2,7 | .14 | 3,6 | 9048H | PR 142-106 HR Tan | .20 | 5,0 | .06 | 1,6 | .25 | 6,4 | 118 | 1 | |
| | | .12 | 3,0 | .16 | 4,0 | 9050H | PR 142-118 HR Tan | .22 | 5,6 | | | | | | | |
| .161 | 4,1 | .10 | 2,5 | .14 | 3,5 | 9058H | PR 161-098 HR Tan | .20 | 5,0 | | | | | | | |
| | | .14 | 3,5 | .18 | 4,5 | 9060H | PR 161-138 HR Tan | .24 | 6,0 | | | | | | | |
| | | .18 | 4,5 | .22 | 5,5 | 9062H | PR 161-177 HR Tan | .28 | 7,0 | .07 | 1,8 | .32 | 8,0 | 196 | 1 | |
| | | .22 | 5,5 | .26 | 6,5 | 9064H | PR 161-217 HR Tan | .32 | 8,0 | | | | | | | |
| | | .30 | 7,5 | .34 | 8,5 | 9068H | PR 161-295 HR Tan | .39 | 10,0 | | | | | | | |

Standard color tan (beige).

| | |
|---------------------|-------------------------------|
| Material | Nylon 4/6 |
| Flammability Rating | 94V-2 |
| Temperature Range | -4°F (-18°C) to 266°F (130°C) |

Quick Specs